

**SPEIRS
MAJOR**

SKP Chengdu,
China

**LIGHT
ARCHITECTURE**

8 Shepherdess Walk
London,
N1 7LB
United Kingdom

T +44 (0)20 7067 4700

Co-lab Shibuya Cast
23-21, Shibuya 1-Chome
Tokyo 150-0002
Japan

T +81 (0)3 3400 8855

info@smlightarchitecture.com
press@smlightarchitecture.com

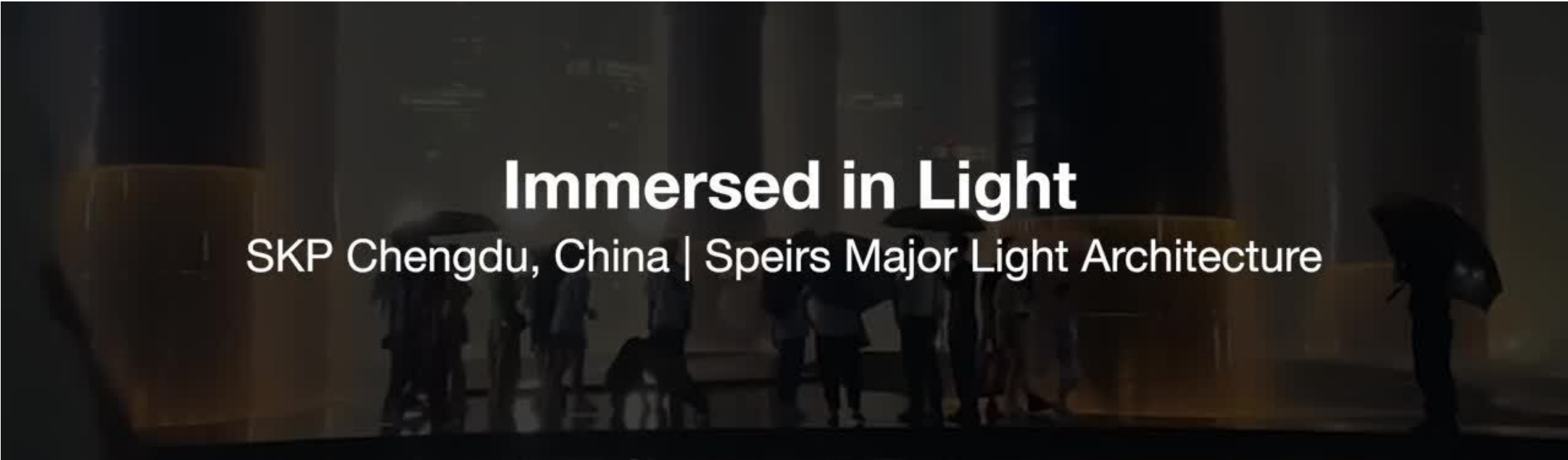

Immersed in Light

SKP Chengdu, China | Speirs Major Light Architecture

Within a greenbelt site in China, SKP Chengdu is the largest ever sustainable luxury retail masterplan. Lighting plays a key role in activating the site at night, making the park feel comfortable and attractive while providing visual cues to the retail beneath.

CLIENT
SKP

DATE
2019-2022

ARCHITECT
Sybarite

LANDSCAPE ARCHITECT
Field Operations

FAÇADE ENGINEER
Eckersley
O'Callaghan

WATER FEATURE DESIGN
The Fountain
Workshop

PROJECT TEAM
Keith Bradshaw,
Benz Roos, Justyna
Ashcroft, Marina
Andronescu

SPEIRS MAJOR



Canyon-like avenues cut into the landscape and connect the half-a-million square metres of submerged retail environments known as SKP-N (North) and SKP-S (South). These are encircled at park level by lit handrails, providing a buffer between the landscape and the retail and assisting with wayfinding and orientation.



With multiple ways to descend, each entranceway has its own character. The open stair is a grand descent, lit simply by light along the handrail, keeping the focus firmly on the retail vista ahead. Several escalator entrances feature backlit shimmering mirrored wall panels and eccentric linear roof lights, supporting a glamorous, lively transition.

SPEIRS MAJOR



SPEIRS MAJOR



SPEIRS MAJOR



The 'Tower of Life' sit above SKP-S

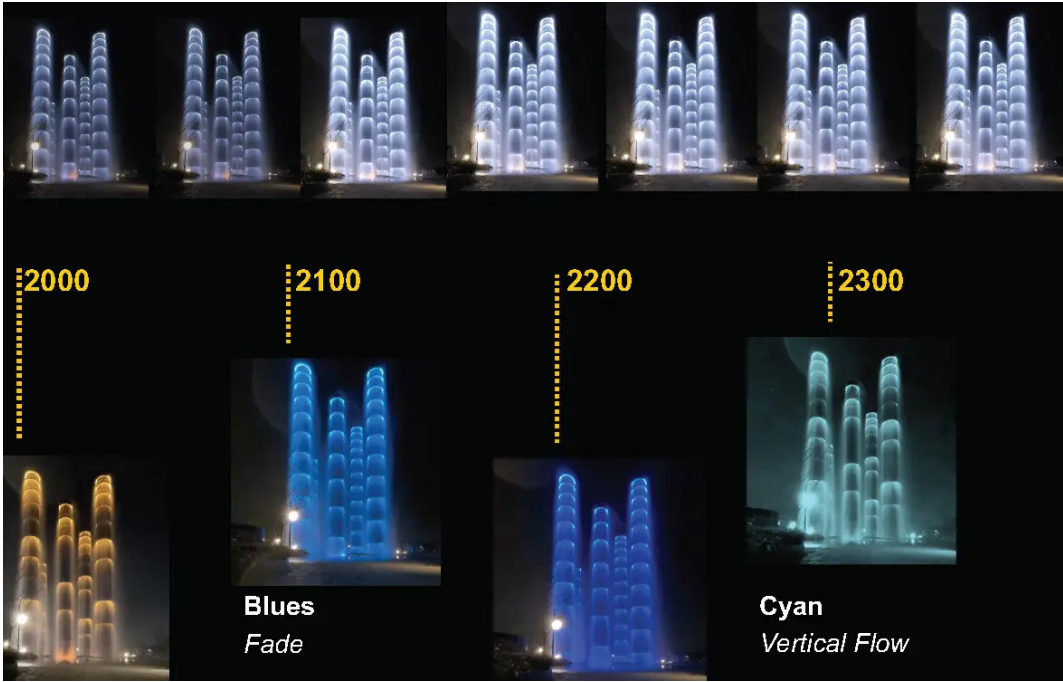

Light sequence



SPEIRS MAJOR



SPEIRS MAJOR



SPEIRS MAJOR



SPEIRS MAJOR



While SKP-N is the high-end retail zone, SKP-S is the more cutting-edge, fashion-forward zone. Here, the design is more brutalist, and the lighting reflects this with more monochromatic light and an industrial aesthetic.



SPEIRS MAJOR

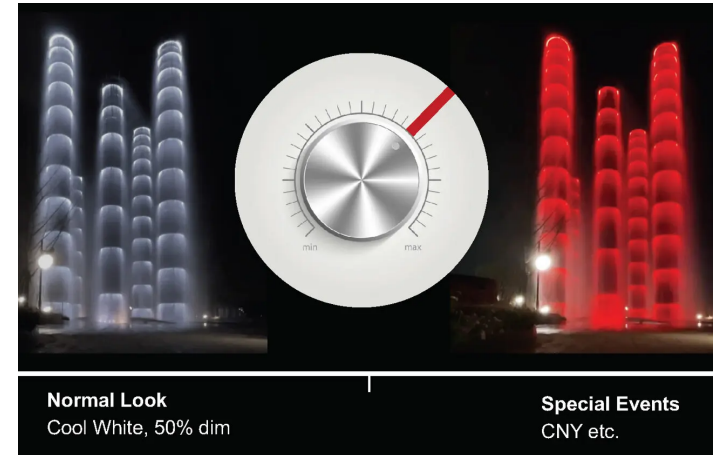
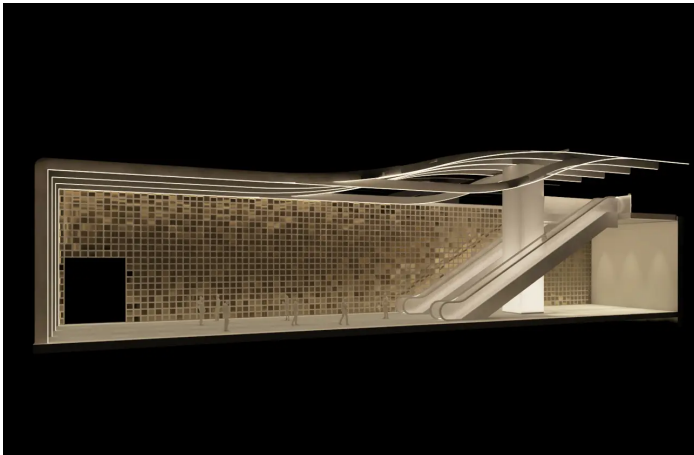
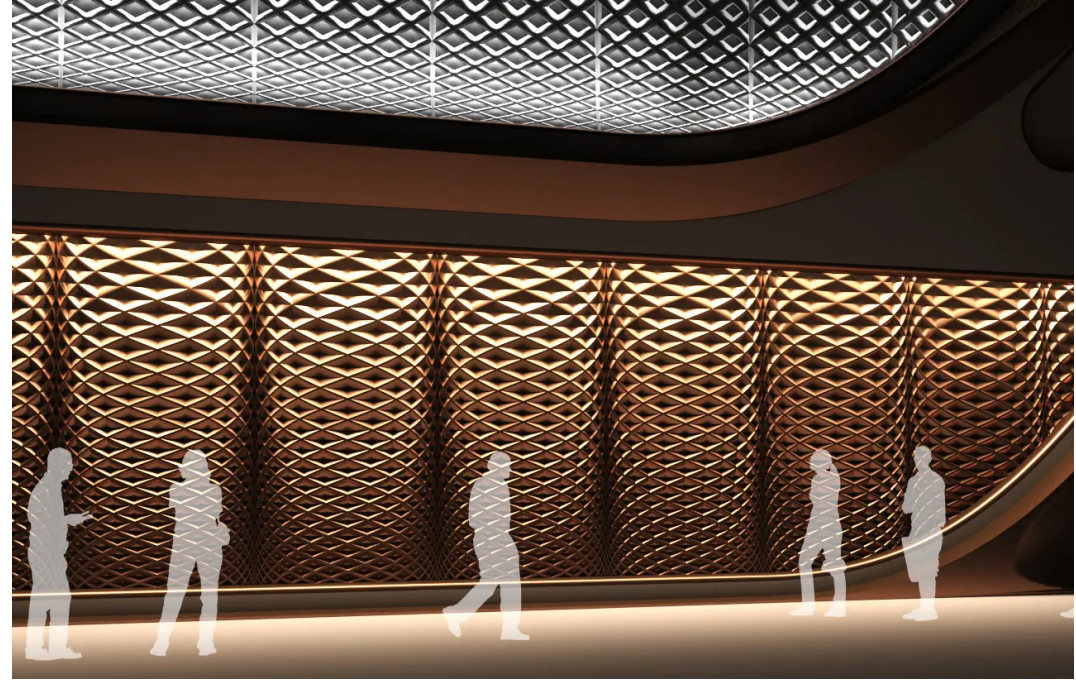
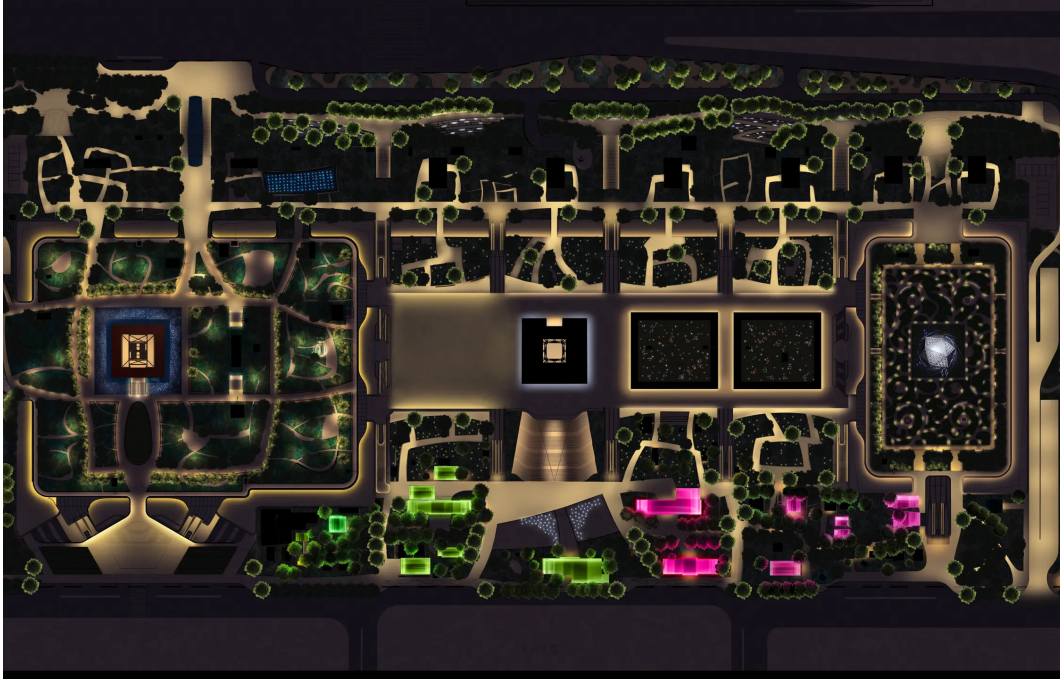

Development sketches